

Dimensions

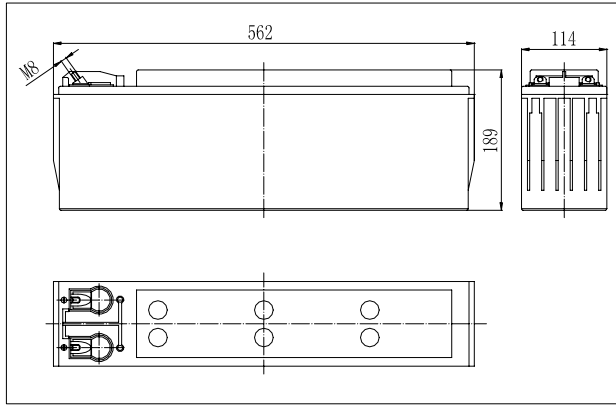

Specifications

Nominal Voltage	12 V	
Capacity(10HR, 25°C)	75Ah	
Dimension	Length	562mm (22.13inch)
	Width	114mm (4.49inch)
	Height	189mm (7.44inch)
	Total Height	189mm (7.44inch)
Approx. Weight	28.5kg (62.8lbs)	
Internal resistance (Fully charged, 25°C)	Approx.5.5mΩ	
Capacity affected by temperature (10HR)	40°C	102%
	25°C	100%
	0°C	85%
	-15°C	65%
Self-discharge (25°C)	3 month	Remaining Capacity: 91%
	6 month	Remaining Capacity: 82%
	12 month	Remaining Capacity: 65%
Nominal operating temperature	25°C ± 3°C (77°F ± 5°F)	
Operating temperature range	-15°C ~ 50°C (5°F ~ 122°F)	
Float charging voltage(25°C)	13.50 to 13.80V	
Cyclic charging voltage(25°C)	14.50 to 14.90V	
Maximum charging current	22.5A	
Terminal type	M8 threaded post	
Maximum discharge current	750A(5 sec.)	

- ◆ Absorbent glass mat technology;
- ◆ Recognized by UL & CE;
- ◆ ABS container.

Charging Characteristics(25°C)

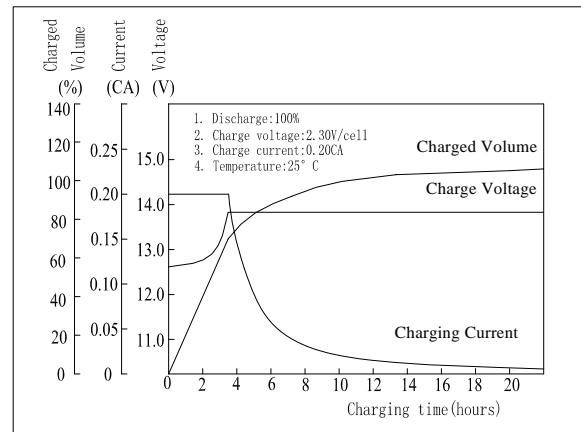

Floating Life Characteristics (25°C)

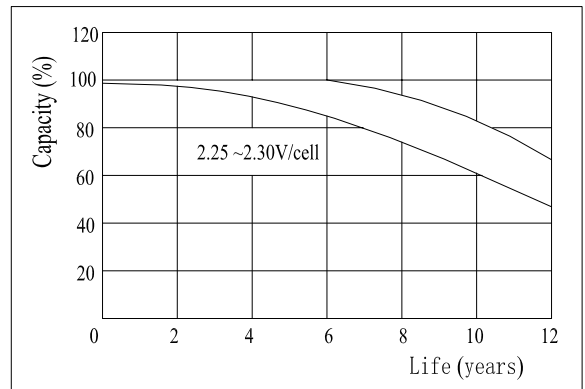

Note: Floating life at 20°C designed for more than 12 years.

Constant Current Discharge Characteristics (A, 25°C)

F.V/TIME	5min	10min	15min	30min	60min	3h	5h	10h	20h
9.60V	237	158	124	78.0	47.2	19.4	13.8	7.62	4.00
10.2V	224	150	119	74.9	45.4	19.1	13.5	7.55	3.96
10.8V	211	140	113	71.2	43.1	18.8	13.3	7.50	3.94

Constant Power Discharge Characteristics (Watt, 25°C)

F.V/TIME	5min	10min	15min	30min	60min	3h	5h	10h	20h
9.60V	2481	1701	1359	875	538	228	162	90.9	48.0
10.2V	2357	1616	1305	840	517	225	160	90.1	47.5
10.8V	2215	1519	1239	798	491	220	157	90.1	47.2